

10. Assembly drawings

10.1 RT and UA axes

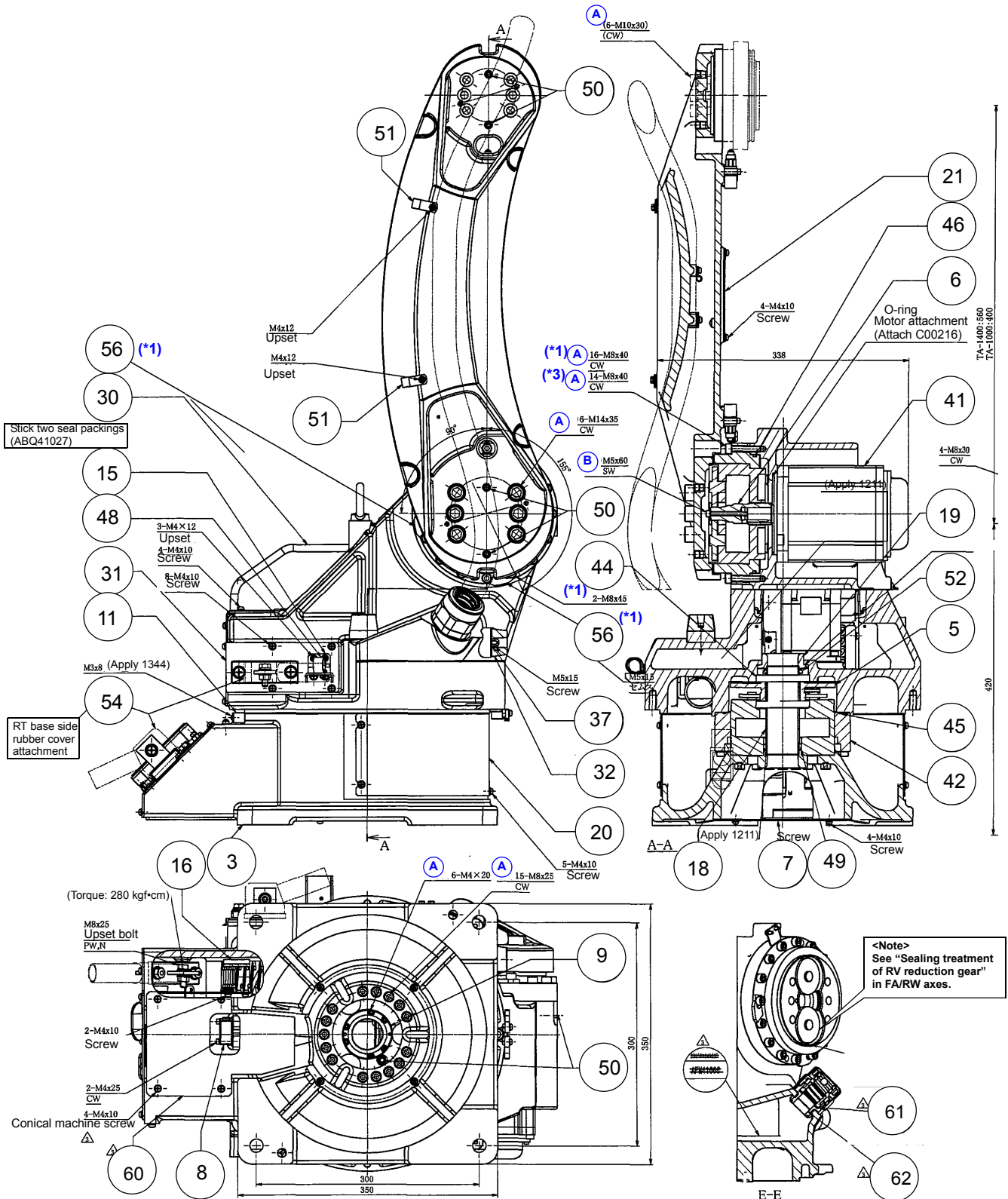

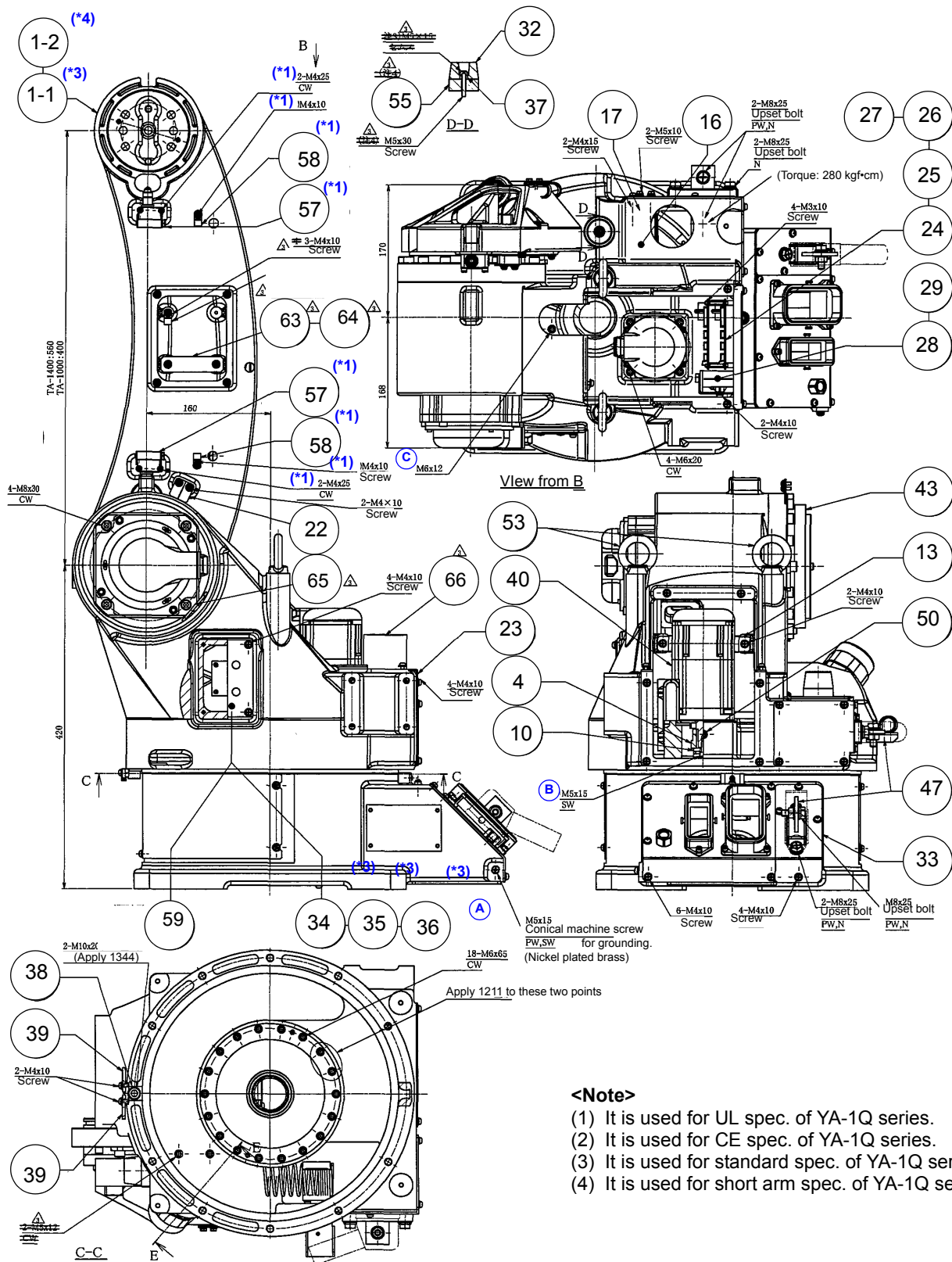

10.2 RT/UA-axis parts list

No.	Part name	Part number	Q'ty	Note	Class
1-1	UA arm	ADA11097	1	TA-1400	D
1-2	UA arm	ADA11099	1	TA-1000	D
2	UA body	ADA11089	1		D
3	RT base	ADB12003	1		D
4	Pinion gear 31	ADG41078	1		B
5	Input gear 31	ADG32009	1		B
6	Input gear 40	ADG32014	1		B
7	RTbottom cover	ADK41057	1		B
8	Limit SW ass'y	AEB31005	1		C
9	Tube holder 35C	AFM32032	1		D
10	Motor collar 082	AFM40262	1		D
11	RT stopper	ABQ41025	1		D
13	Swiveling H fixing bracket	AFM41657	1		D
14	Wrist H fixing bracket	AFM41666	1	Note1)	D
15	Cable plate	AFM41674	1		D
16	Saddle	AFS41020	2		D
17	Saddle space	AGA41054	1		D
18	Inner tube	AGG41054	1		D
19	Harness guide RT	AGG41055	1		D
20	RT base cover	AGK31027	1		D
21	UA arm cover	ADK41056	1		D
22	Marking plate	AKC41092	1		D
23	RSIF mounting plate	AKK32048	1		D
24	Resolver card	ZUEP5764	1		C
25	Resolver card	ZUEP5764A1	1		C
26	PCBoard spacer	SQ20	4		D
27	Spacer	WLS20-0			D
28	Battery case	AKH41006	1		D
29	Lithium battery	ER6VCT	6		A
30	RT motor cover	AKK22008	1		D
31	Terminal fixing bracket	AKK32046	1		D
32	Rubber stopper H22	ABQ41007	2		D
33	Terminal plate	AKK32047	1		D
34	BKSW mounting plate	AKK41136	1		D
35	Brake card	ZUEP5759	1		C
36	Spacer	KGLS8RT	4		D
37	Stopper collar	AMK41060	2		D
38	RT dog base	ASB41002	1		D
39	Dog RT	ASM41040	2		D
40	Servo motor	TS4614N8323	1	RT axis	C
41	Servo motor	TS4832N9030	1	UA axis	C
42	RV35C reduction gear	28L001-0	1	RT axis	C

2

No.	Part name	Part number	Q'ty	Note	Class
43	RV40E reduction gear	35E029K0	1	UA axis	C
44	Bearing	6811ZZ	1		B
45	O ring	AS568-163	1	RT axis	A
46	O ring	AS568-258	1	UA axis	A
47	Terminal	KET09001	2		A
48	Nylon clamp	NK12N	1		A
49	O ring	S48NBR	1		A
50	Sunk plug	SP1/8B	7		D
51	Nylon clamp	NK11N	2		A
52	V ring	V45A	1		A
53	Eyebolt	XVN12FJ	2		D
54	Rubber cover	AWK41012	2		D
55	Stopper collar	AGA41055	1	TA-1000 only Note2)	D
56	Limit dogR40	ASM41041	2	U type only	D
57	Limit SW ass'y	AEB31005	2	U type only	C
58	Nylon clamp	NK4N	2	U type only	A
59	BK release unit	AEU01418	2	E/U types only	C
60	Swiveling H cover	ADK41060			
61	Spacer	AFQ41238			
62	Connector	KMBG36MG4			
63	Saddle	AFS41023			
64	Fixing plate	AFP41223			
65	UA rubber cover	AFQ41239			
66	Resolver card cover	AZS31003			

Note 1) Not used from the products manufactured in October, 2006 onwards.
 2) Also used for TA-1400 from the products manufactured in October, 2006 onwards.

<Class>

- A: Consumable parts, rather short replacement cycle.
- B: Assemblies and parts of high frequency in motion.
- C: Important electric parts.
- D: Parts rather long replacement cycle.